

## HUSH UP - ACOUSTIC GREEN WALL PANELING

Nature-inspired solution to noise reduction  
UpScapers panels provide the perfect sound absorption materials for deadening and dampening sound in restaurants, offices and many more spaces.

- .84 SAA
- .85 NRC

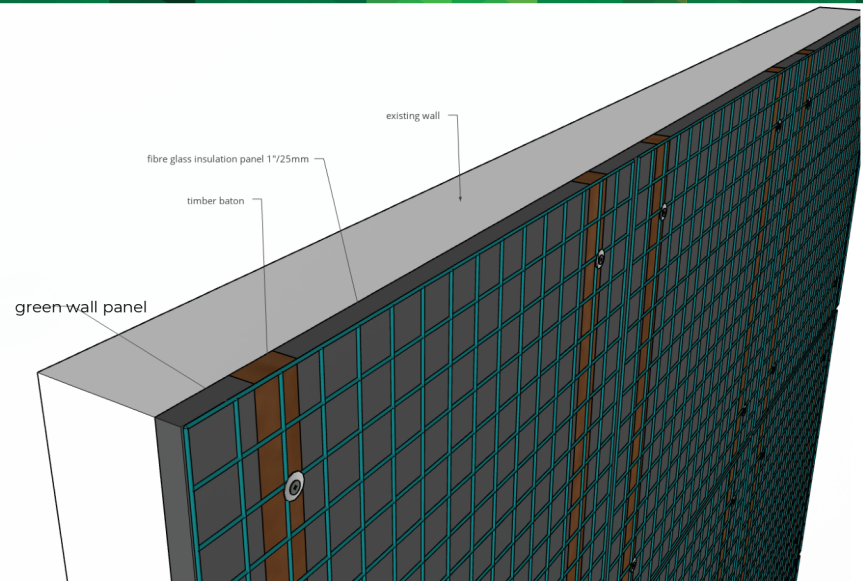

Technical Specifications		
Dimensions (WxL)   Depth	31.5"x31.5"	up to 8"
Weight	13.2 lbs	
Distribution	Thick Multi-Dimensional Plantings	
Plants	Faux plants dispersed among three SS panels fastened with 1.55 mm SS wire	
Color	Mixed	
Coverage	6.89 sq. ft.	
Stainless Steel Frame	8 gauge Coated, 2" Square SS Mesh Grid	
SS Frame Coating	Powder Coating Green	
Plant Ties	1.mm SS wire	
Color	Varied	
UV	ASTM G154 AATCC 16.3	
Fire Testing	NFPA 701, ASTM E84, NFPA 286	
Heat Build Up	31.7° C	
Freeze/Thaw	MIL-STD-810G Method 524	
Packing	Box of three panels A, B, C	
Airflow	< 25%	
Anchors	Variable based on substrate - see manufacturer's recommended installation instructions.	

## ENGINEERED FOR

- General Beautification
- Biophilic Design Benefits
- Privacy Screening
- Visual Screening
- Wind Breaks
- Spatial Unity
- Concrete Softening
- Acoustic Outcomes
- Artificial Green Roofs



CADdetails



For more information, visit [upscapers.com](https://upscapers.com).  
Email: [info@UpScapers.com](mailto:info@UpScapers.com). Call 866-950-5769.